

# MODEL SWF-SIDEWALL FAN

(For High Static Pressure Applications with Minimum Space)



61A Baywood Road  
 Toronto, ON M9V 3Y8  
 Tel: 1-866-733-0233  
 Fax: 1-866-358-5346  
 www.solerpalaucanada.com

## Dimensions inches/mm

Model	A	B	C	C1	C2	D
SWF-100	13 1/4 / 337	13 1/4 / 337	9 / 228	3 / 76	2 7/16 / 62	4 / 100
SWF-100x	13 1/4 / 337	13 1/4 / 337	9 / 228	3 / 76	2 7/16 / 62	4 / 100
SWF-150	15 1/2 / 394	13 1/4 / 337	10 3/16 / 256	3 / 76	2 7/16 / 62	6 / 150
SWF-150x	15 1/2 / 394	16 1/16 / 408	10 / 254	3 3/16 / 81	2 7/16 / 62	6 / 150
SWF-200	15 1/2 / 394	16 1/16 / 408	11 7/16 / 290	3 3/8 / 87	2 7/16 / 62	8 / 200

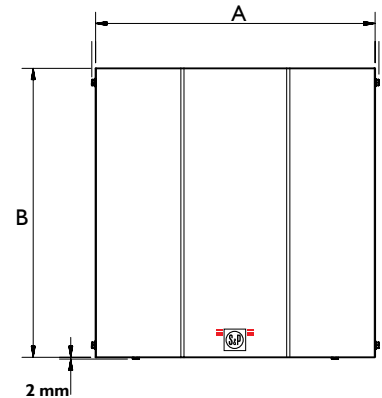
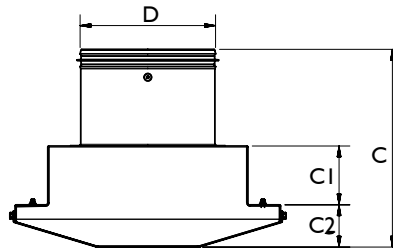

FAN DATA					
Fan No.	Qty.	Model No.	CFM	SP	RPM

MOTOR DATA					
AMPS	RPM	VOLTS	PH	HZ	ENCLOSURE

For more information contact us at [www.solerpalau-usa.com](http://www.solerpalau-usa.com) or 1.800.961.7370 for additional submittal drawings.

Soler & Palau will not be responsible for fabrication changes or errors resulting from customer use of a non-current submittal drawing.

ACCESSORIES	1	2	3	4	5	REMARKS

PROJECT: \_\_\_\_\_ CONTRACTOR: \_\_\_\_\_  
 LOCATION: \_\_\_\_\_ REVISION DATE: \_\_\_\_\_  
 FORM NO.: \_\_\_\_\_ SUBMITTED BY: \_\_\_\_\_ DATE: \_\_\_\_\_  
 ENGINEER: \_\_\_\_\_ APPROVED BY: \_\_\_\_\_ DATE: \_\_\_\_\_

